

**Nidec**  
All for dreams

**KINEX**

***EH series***  
***High Precision Large Size Reducer***



**NIDEC DRIVE TECHNOLOGY CORPORATION**

# EH-N

## Solid shaft type

The solid shaft type (EH-N type) offers high torque density by integrating the motor and reducer on the same shaft. This design reduces mechanical complexity and optimizes space usage, making it ideal for applications that require both compactness and power.

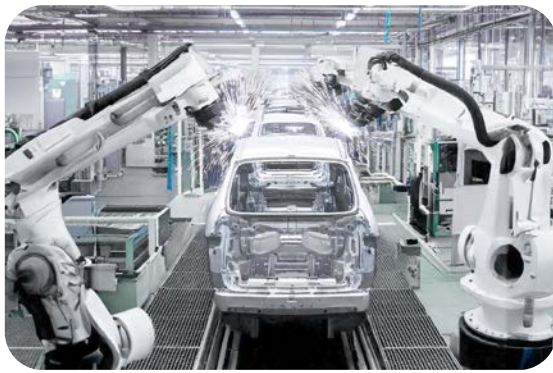

## 1 HIGH RIGIDITY

KINEX series gearbox offers exceptional high rigidity, designed specifically for six-axis robots to ensure stability, minimize deformation under heavy loads, and deliver reliable, high-torque performance.

## 2 HIGH ACCURACY

KINEX series gearbox offers high accuracy for precise positioning in diverse applications, including arc welding, ensuring minimal backlash and reliable performance.

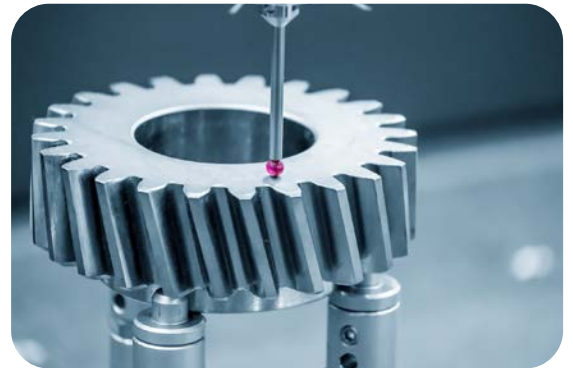

## 3 LOW NOISE

Our innovative gear reducers tackle the noise issues commonly associated with traditional models, providing a low-noise solution that enhances efficiency and improves the overall user experience.

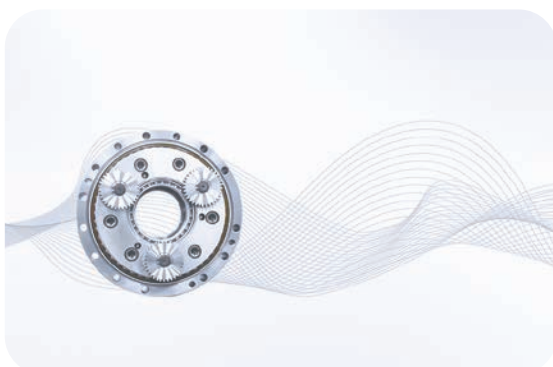



# EH-C

## Hollow shaft type



The EH-C type's design features a hollow shaft allowing for cables and connections to pass through - ideal for internal wiring - and enabling an offset design for the motor and reducer.

## Achieve excellent motion with Nidec gearbox

We deliver tailored solutions that blend performance and cost-efficiency across various sizes, from low to high precision — your all-in-one solution for every need.



## One-Stop Gearbox Solutions

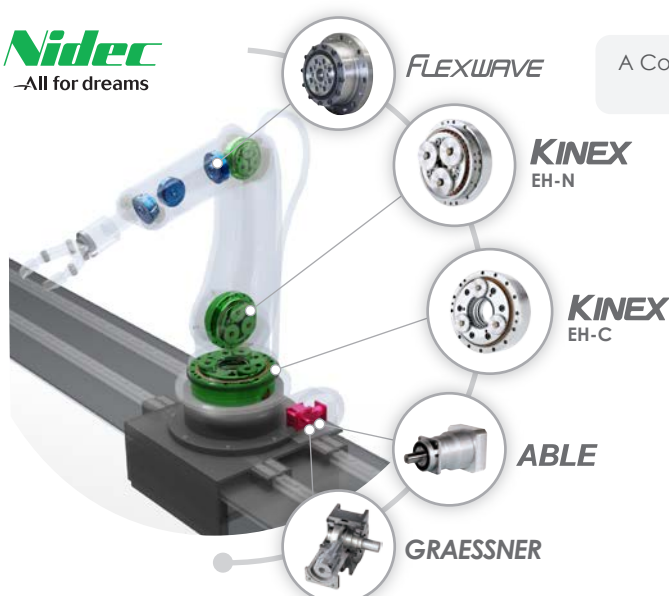

A Comprehensive Gearbox Lineup For Streamlined Purchasing, Easy Maintenance, And Efficient Stock Management

Consistent Dimensions With Existing Brands As A Fully Compatible Replacement

High Torsional Rigidity & Low Backlash For Smooth Running

Customized Gearbox Available

# Application

Our new gearboxes feature zero backlash and high output torque in a lightweight, compact design, ensuring high stiffness, making them ideal for robotic applications, automatic tools and other machinery that require exceptional positional accuracy.

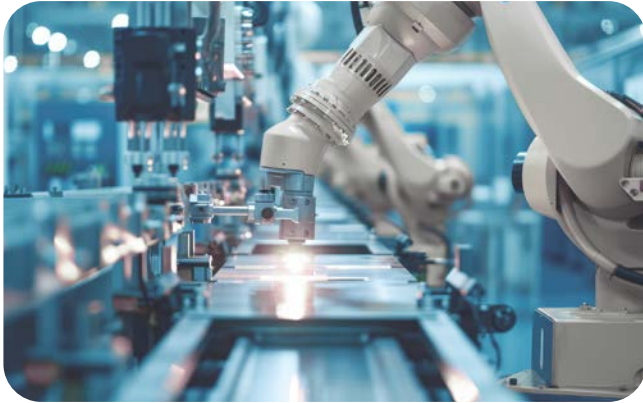

Articulated Robot



Wafer-transfer Robot



Positioner

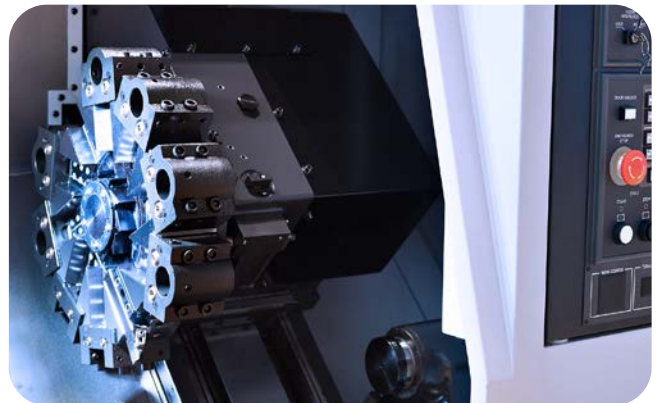

Automatic Tool Changer



Turret Head



Index Table

## Model Nomenclature

<b>EH</b>	—		—	
Series		Size		Type
		<b>N</b> : 25,42,80,125		<b>N</b> : Solid shaft type
		<b>C</b> : 50,120		<b>C</b> : Hollow shaft type

## Specification

Product Model	Ratio		* 1							* 2		
	Output flange rotation	Frame Rotation	Rated torque (Nm)	Rated output Speed (rpm)	Rated service life (h)	Allowable acceleration/ deceleration torque (Nm)	Momentary maximum allowable torque (Nm)	Backlash/ Lost motion (arc min)	Transmission Angular Accuracy (arc sec)	Allowable moment (Nm)	Momentary allowable moment(Max.) (Nm)	Mass (kg)
EH-25N	41	40	245	15	6,000	612	1,225	1.0/1.0	70	784	1,568	3.8
	81	80										
	107.67	106.67										
	126	125										
	137	136										
EH-42N	164.07	163.07	412	15	6,000	1,029	2,058	1.0/1.0	60	1,660	3,320	6.3
	41	40										
	81	80										
	105	104										
	126	125										
EH-80N	141	140	784	15	6,000	1,960	3,920	1.0/1.0	50	2,150	4,300	9.8
	164.08	163.08										
	41	40										
	81	80										
	101	100										
EH-125N	129	128	1,225	15	6,000	3,062	6,125	1.0/1.0	50	3,430	6,860	15
	141	140										
	171	170										
	41	40										
	81	80										
EH-50C	102.18	101.18	490	15	6,000	1,225	(Bolt) 2,450	1.0/1.0	60	1,764	3,528	16.4
	121	120										
	145.62	144.62										
	161	160										
	32.54	31.54										
EH-120C	36.75	35.75	1,177	15	6,000	2,940	5,880	1.0/1.0	50	3,920	7,350	21.2

- No-load running torque will increase when the reducer is used at low temperature. Please be careful when selecting a motor.
- If you require a reduction ratio other than the above, or if you have any questions regarding motor selection, please contact our sales representative.
- The above specifications are based on our evaluation method. The customer is requested to use the product only after confirming that there are no problems under the operating conditions of the actual equipment to be installed.

\* 1. The rated torque is the torque value that corresponds to the rated lifetime when operating at the rated output rotation speed, and does not indicate the upper limit of the load.

\* 2. The allowable moment changes depending on the axial load.

## Dimension Table

Size / Type		EH-25N	EH-42N	EH-80N	EH-125N	EH-50C	EH-120C
A [Width]	mm	62	66	75	81	79	82.5
B [Outer diameter]	mm	133	159	189	221	222	250
C [Output side pilot diameter]	mm	94	118	140	160	176	199
D [Input side pilot diameter]	mm	113	136	160	186	169	192
E [Center hole diameter]	mm	24	30	35	40	66	73
F [Inner diameter of the Bearing]	mm	-				65(-0.015 to 0)	80(-0.015 to 0)

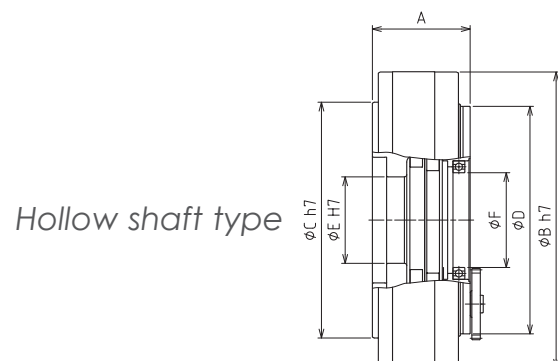
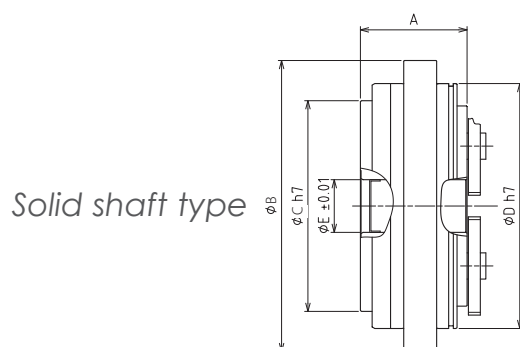



## WORLDWIDE SALES, SERVICE & SUPPORT

<b>NIDEC DRIVE TECHNOLOGY CORPORATION</b>	Nidec PARK Bldg.C, 1-1 Higashinokuchi, Morimoto-cho, Muko-shi, Kyoto, 617-0003, Japan	+81-75-280-3777
<b>NIDEC DRIVE TECHNOLOGY KOREA CORPORATION</b>	#317, Kolon sciencevally II, 55, Digital-ro 34-gil, Guro-gu, Seoul 08378, Korea	+82-2-2038-3537
<b>NIDEC DRIVE TECHNOLOGY TAIWAN CORPORATION</b>	Taiwan Boulevard, Xitun Dist., Taichung City 40767, Taiwan	+886-4-2358-2628
<b>NIDEC DRIVE TECHNOLOGY (ZHEJIANG) CORPORATION</b>	Pinghu Economic Development Zone, Zhejiang, China	+86-573-85098651
<b>NIDEC MECHANICAL (SHANGHAI) DRIVE TECHNOLOGY Co., Ltd.</b>	100 Zunyi Road, Chang Ning District, Shanghai, China	+86-21-64400700
<b>NIDEC DRIVE TECHNOLOGY INDIA PRIVATE LIMITED</b>	BVR Lake Front, No. 40/32/50/1/2, Nagavara Village, Kasaba Hobli, Near Ring Road, Veerannapalya, Arabi College Post, Bangalore -560 045, India	+91-80-4953-6579
<b>NIDEC DESCH ANTRIEBSTECHNIK GmbH &amp; Co.KG</b>	Kleinbahnstraße 21, 59759 Arnsberg, Germany	+49-2932-300-0
<b>NIDEC GRAESSNER GmbH &amp; Co.KG</b>	Kuchenäcker 11, 72135 Dettenhausen, Germany	+49-7157-1230
<b>NIDEC DRIVE TECHNOLOGY AMERICA CORPORATION</b>	175 Wall Street, Glendale Heights, IL60139, USA	+1-800-842-1479
<b>NIDEC DRIVE TECHNOLOGY DO BRASIL Ltda.</b>	Rua Luis Gois, 1586, S34-A, São Paulo – SP 04043-200 Brazil	+55-11-5071-0015



### YouTube



@NIDEC DRIVE TECHNOLOGY

### Instagram



@desch\_group

### LinkedIn



@DESCH Group



@NIDEC DRIVE TECHNOLOGY AMERICA

Europe

Europe

USA

## NIDEC DRIVE TECHNOLOGY CORPORATION

〈Web Page Information〉 Please scan the QR code or access the URL below.



### Contact Us

<https://www.nidec.com/en/nidec-drivetechnology/inquiry/>



### Sales Offices

<https://www.nidec.com/en/nidec-drivetechnology/corporate/network/sales/>